

## Technical Data Sheet

### 3mm LED: SLR3006

#### ■ Features

- Dominant Wavelength 621nm
- Super brightness
- Pb free
- The product itself will remain within RoHS compliant version.

#### ■ Descriptions

The SLR3006 is specially designed for applications requiring super brightness.

#### ■ Applications

- Security system
- Fiber Amplifier
- Optoelectronic switch

#### ■ Package Dimensions

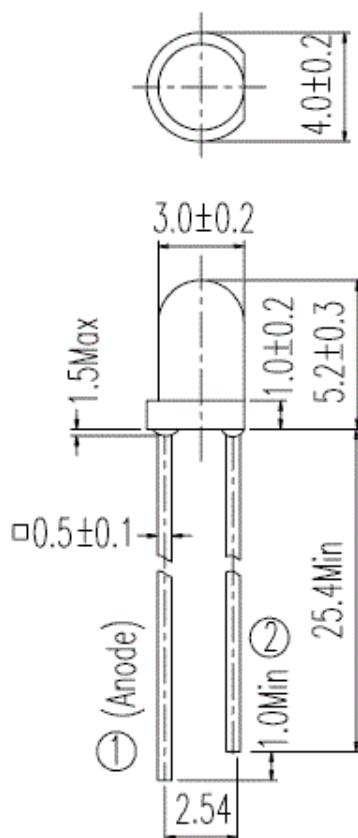

#### Notes:

1. All dimensions are in millimeters
2. Tolerances unless dimensions  $\pm 0.25\text{mm}$

说明：

1. 所有尺寸单位为毫米
2. 未注明的公差为  $\pm 0.25\text{mm}$



① Anode 正极

② Cathode 负极

■ **Absolute Maximum Ratings (Ta=25°C)**

Parameter	Symbol	Rating	Units
Continuous Forward Current	I <sub>F</sub>	25	mA
Peak Forward Current (Duty 1/10 @ 1KHZ)	I <sub>PF</sub>	60	mA
Reverse Voltage	V <sub>R</sub>	5	V
Power Dissipation	P <sub>d</sub>	60	mW
Lead Soldering Temperature	T <sub>sol</sub>	260	°C
Operating Temperature	T <sub>opr</sub>	-40 ~ +85	°C
Storage Temperature	T <sub>stg</sub>	-40 ~ +100	°C

■ **Electro-Optical Characteristics (Ta=25°C)**

Parameter	Symbol	Condition	Min.	Typ.	Max.	Units
Luminous Intensity	I <sub>v</sub>	I <sub>F</sub> =20mA	60	75	--	cd
Viewing Angle	2θ <sub>1/2</sub>	I <sub>F</sub> =20mA	--	20	--	deg
Dominant Wavelength	λ <sub>d</sub>	I <sub>F</sub> =20mA	--	621	--	nm
Spectrum Radiation Bandwidth	Δλ	I <sub>F</sub> =20mA	--	20	--	nm
Forward Voltage	V <sub>F</sub>	I <sub>F</sub> =20mA	1.8	2.0	2.3	V
Reverse Current	I <sub>R</sub>	V <sub>R</sub> =5V	--	--	10	μA

■ **Typical Electro-Optical Characteristics Curves**

**Relative Intensity vs. Wavelength (Ta=25°C)**

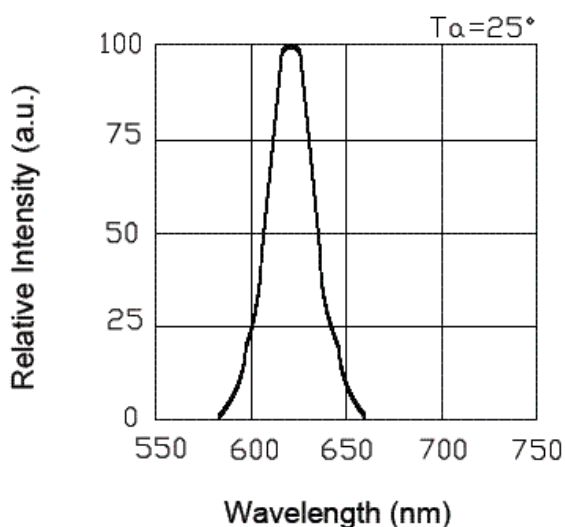

**Directivity (Ta=25°C)**

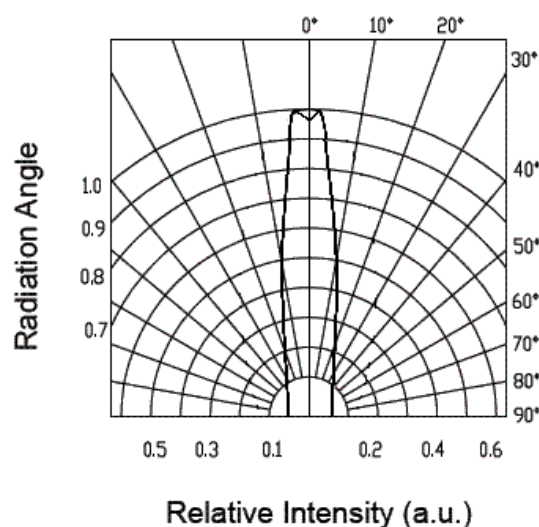

**Forward Current vs. Forward Voltage (Ta=25°C)**

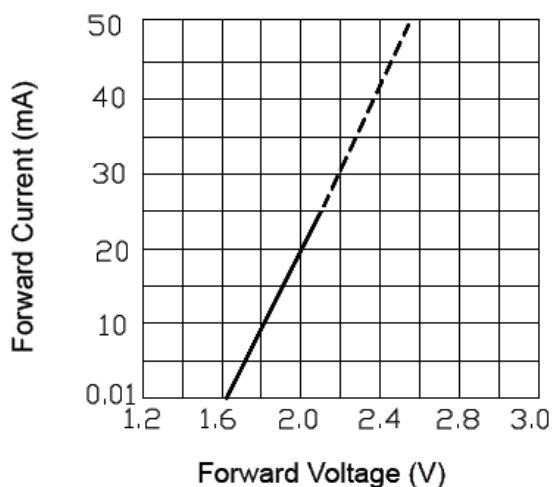

**Relative Intensity vs. Forward Current (Ta=25°C)**

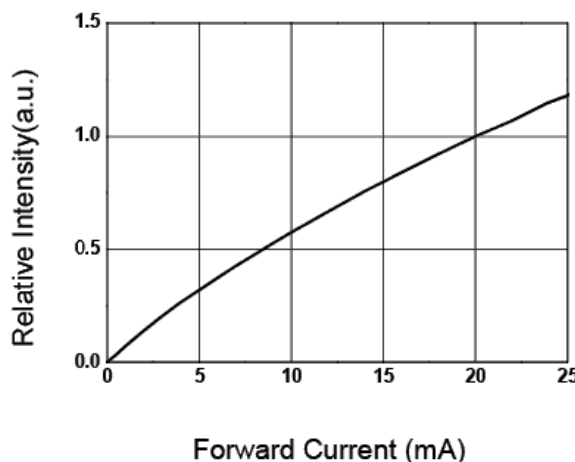

**Relative Intensity vs. Ambient Temp.**

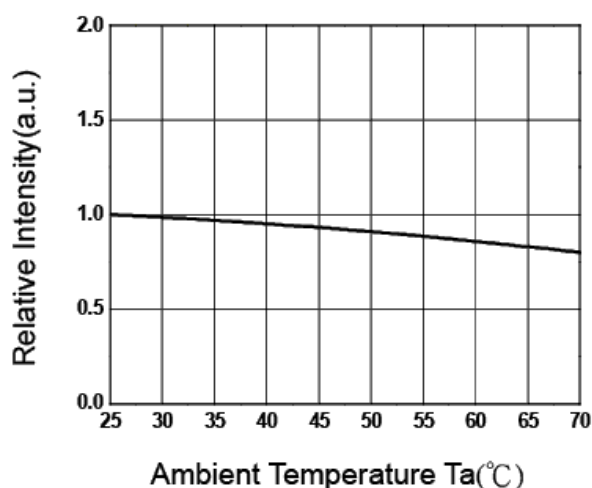

**Forward Current vs. Ambient Temp.**

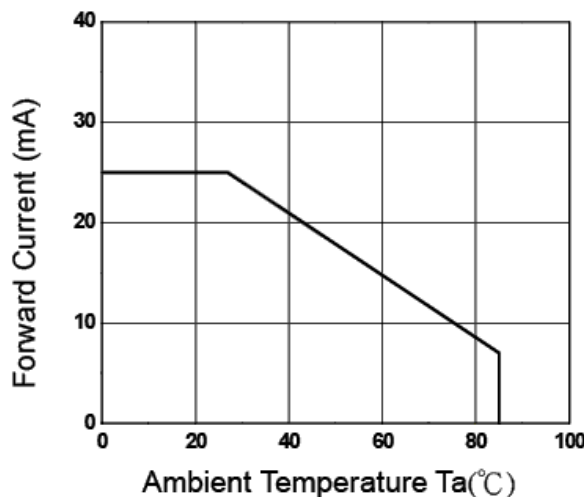

## ■ Packing Quantity Specification

1. 1000PCS/1Bag

## ■ Notes

1. Above specification may be changed without notice. SHUGUAN will reserve authority on material change for above specification.
2. When using this product, please observe the absolute maximum ratings and the instructions for using outlined in these specification sheets. SHUGUAN assumes no responsibility for any damage resulting from use of the product which does not comply with the absolute maximum ratings and the instructions included in these specification sheets.
3. These specification sheets include materials protected under copyright of SHUGUAN corporation. Please don't reproduce or cause anyone to reproduce them without SHUGUAN's consent.